

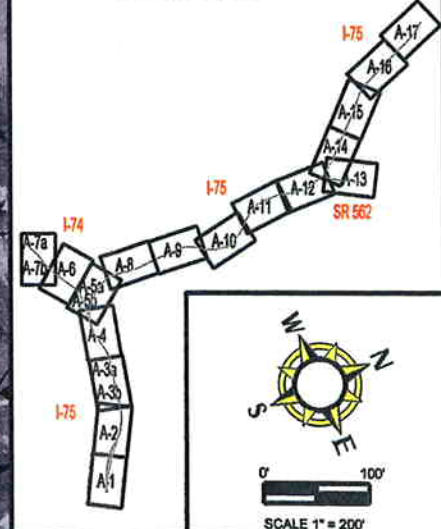

MILL CREEK EXPRESSWAY
HAM-75-2.30 PID#76257

SHEET KEY



MAP LEGEND

- CONCEPTUAL ALTERNATIVE
- EXISTING RIGHT OF WAY
- CONSTRUCTION LIMITS
- RETAINING WALL
- POTENTIAL BUILDING DEMOLISHED
- PARK LAND
- RAMP CLOSED

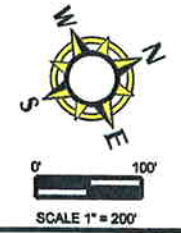

4 LANE CONTINUITY ALTERNATIVE



TRANSYSTEMS

PDP STEP 5
 MARCH
 2006

A-15